

DS-2CD2022-I (2.0MP)

DS-2CD2032-I (3.0MP)

IR Mini Bullet Network Camera

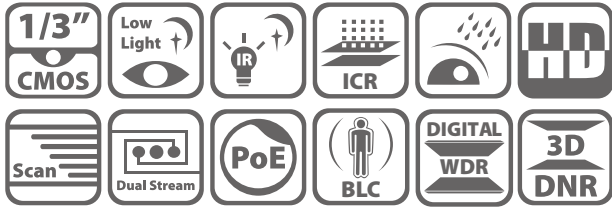

Key features

- 2MP / 3MP high resolution
- HD real-time video
- 3D DNR & DWDR & BLC
- IR LEDs: up to 30m
- IP66
- PoE
- Compact design
- Bracket included

Dimensions

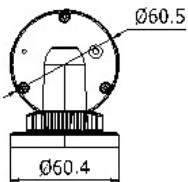
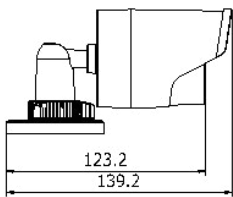
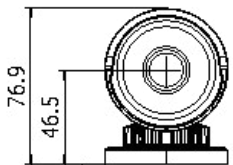

Unit: mm

Available models

DS-2CD2022-I (2.0MP)

DS-2CD2032-I (3.0MP)

* 1.3MP model is also available -- DS-2CD2012-I

	DS-2CD2022-I	DS-2CD2032-I
Camera		
Image sensor	1/3" progressive scan CMOS	
Min. illumination	0.01 lux @F1.2, AGC ON, 0 lux with IR	0.07 lux @F1.2, AGC ON, 0 lux with IR
Shutter time	1/3s ~ 1/100,100s	
Lens	4mm @ F2.0 (6mm optional) Angle of view: 79°(4mm), 49°(6mm)	4mm @ F2.0 (6mm optional) 1920 × 1080: Angle of view: 79°(4mm), 49°(6mm) 2048 × 1536: Angle of view: 70°(4mm),43.3°(6mm)
Lens mount	M12	
Day & night	ICR	
Digital noise reduction	3D DNR	
Wide dynamic range	Digital WDR	
Compression Standard		
Video compression	H.264 / MJPEG	
H.264 codec profile	Main profile	
Bit rate	32 Kbps ~ 16 Mbps	
Dual stream	Yes	
Image		
Max. Image Resolution	1920 x 1080	2048 x 1536
Frame rate	50Hz: 25fps (1920 x 1080), 25fps (1280 x 720) 60Hz: 30fps (1920 x 1080), 30fps (1280 x 720)	50Hz: 20fps (2048 x 1536), 25fps (1920 x 1080), 25fps (1280 x 720) 60Hz: 20fps (2048 x 1536), 30fps (1920 x 1080), 30fps (1280 x 720)
Image settings	Saturation, brightness, sharpness, contrast, sharpness adjustable through client software or web browser	
BLC	Yes, zone configurable	
Network		
Network storage	NAS	
Alarm trigger	Motion detection, line crossing detection, tampering alarm, scene change detection, face detection, intrusion detection	
Protocols	TCP/IP, ICMP, HTTP, HTTPS, FTP, DHCP, DNS, DDNS, RTP, RTSP, RTCP, PPPoE, NTP, UPnP, SMTP, SNMP, IGMP, 802.1X, QoS, IPv6, Bonjour	
System compatibility	ONVIF, PSIA, CGI	
General functionalities	User Authentication, watermark, reset button	
Interface		
Communication interface	1 RJ45 10 M / 100 M Ethernet interface	
General		
Operating conditions	-30 °C ~ 60 °C (-22°F ~ 140 °F) humidity 95% or less (non-condensing)	
Power supply	12 VDC ± 10% , PoE (802.3af)	
Power consumption	Max. 5W (max. 7W with ICR on)	
Weather proof rating	IP66	
IR range	Up to 30m	
Dimension	60.4 x 76.9 x 139.2mm	
Weight	500g	