

Speedy & Accuracy

Performance when Passion Melts in **Somax** Compact Mini PTZ

360° All-around surveillance



PTZ DOMES

Advantage of PTZ Domes

SDC611 Series

Setup the soft address of speed dome

The soft address is to use the keyboard to connect the speed dome and proceed the setup by the software of machine



Operation in high/low temperature (Optional)

The IP-67 complaint rating provides the highest level of weather and vandal resistance. Operation Temperature is -40°C ~+60°C



Low Temperature



High Temperature

Waterproof and lighting proof

The PTZ Dome support with an IP-67 rated standard waterproof and a 6000V lightning proof to protect the device security.



IP67 Waterproof



6000V Lightningproof

Privacy Masking

The function allow for areas in picture to be masked so that they cannot be viewed or record. This feature is useful in applications where a camera can see into areas that are not relevant to the security purposes for the camera and the owner does not want to be subject to.



Customized Multi-Language and Multi- protocol

Using the convenient multi-language OSD menu that displays camera functions in characters on the screen, you can specify each camera function easily and conveniently. The languages support with English, German, French, Russian, Italian and Spanish. We can add your own language with the transcript you provide.



OSD menu of multi-language

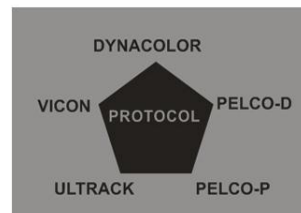

Multi-protocol

Remote upgrade

The SOMAX brand Speed Dome allows you to remote the speed dome and operate the upgrading by connecting with RS485, DVR or internet.

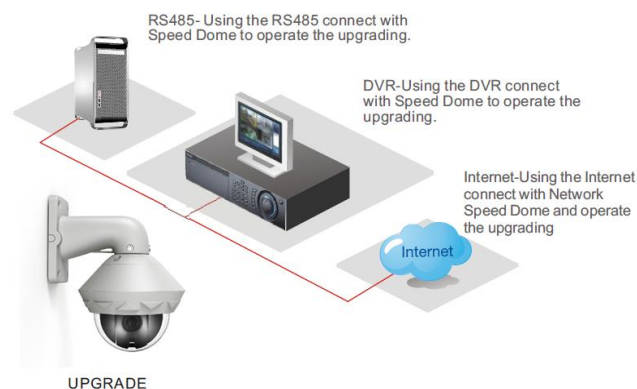

UPGRADE

International Famous Brand Components

Reference to the international Brand Components and used for various types of structure of SOMAX PTZ Domes, including the fan, belt, motor, bearing etc.



© 2010 SOMAX All rights reserved.

All rights of this object belong to SOMAX. Reproduced or transmitted in any form, or by any means without the prior written permission of SOMAX is prohibited. SOMAX reserves the rights to modify its products, including their specifications and any other information stated herein without notice. The official printout of any information shall prevail should there be any discrepancy between the information contained herein and the information contained in that printout. "SOMAX" is a trademark owned by SOMAX. Integrated Other trademarks used herein for description purpose only belong to each of their companies.

SOMAX
TECHNOLOGY OF SECURITY

SM-SDC611-Q10X

4-inch PTZ Dome, 32-bit ARM, IP66-rated, working temperature with 0°C~+50°C & 6000V Lightning proof

10X Optical Zoom



Key Features

- ✓ Support 256 presets, 32-bit software address.
- ✓ 32-bit ARM processor CPU, User management protection.
- ✓ 8 mission planning and 8 Editable vector path.
- ✓ 6 pattern (horizontal/vertical/zoom, and each can record up to 120 seconds).
- ✓ Compatibility with all Protocol: PELCO-D, PELCO-P, ULTRACK, VICON, SYNACOLOR.
- ✓ Compatible with Sony, Hitachi, CNB, Sanyo, Yoko, LG and Samsung.
- ✓ Optional multi-language for OSD operation menu.
- ✓ IP66-Rated waterproof and 6000V Lightning proof.

Dimensions Unit: mm

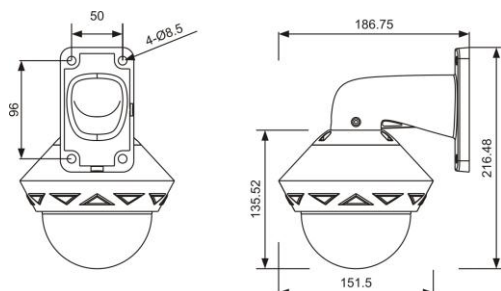

Technical Specification

Model NO.	SM-SDC611-Q10X
Zoom Module	
TV System	PAL/NTSC
CCD Sensor	1/3"SONY CCD
Effective Pixel	597(H)×537(V)
Lens	F=5.5mm~55mm
Zoom	10X Optical Zoom
Mini. Illumination	Color: 0.01LUX B/W:0.001LUX/0LUX
Horizontal Resolution	480TVL
S/N Ratio	>60dB
Electronic Shutter	PAL:1/50~1/10000sec. NTSC : 1/60~1/12000sec.
Video Output	1.0Vp-p 75Ω
Gamma	0.45
Scanning System	Internal Lens
Focus	Manual/Auto
Iris	Manual/Auto
White Balance	Auto
AGC	Manual/Auto
HLC	ON/OFF
Operation	
OSD menu	English, German, Russian, Italian and Spanish
Preset position	128 or 256 Preset Positions Optional
Scan	Auto scan and left-right limited scan, speed adjustable
Patrol	8 tracks, preset, speed and dwell time changeable
Pattern	6 Lines(Pan/Tilt/Zoom, every line can record up to 120 seconds)
Alarm	N/A
Password protection	YES
Temperature display and Settings	YES(Temperature alarm set, Temperature Display)
Authority Management	YES
Private masking	Samsung : 8(Linked Private masking)
Address range	0~255 (Setup by dip switcher, firmware)
Communication	RS485 (+/-)
Baud rate	2400/4800/9600/19200
Protocol	PELCO-D,PELCO-P, ULTRACK, VICON, DYNACOLOR
Device title	Display on/off
Zoom times	Display on/off
Firmware Update interface	RS485 (+/-)
Mechanical	
Pan range	0°~ 360° continuously
Pan speed	0.1~ 360°/s
Tilt range	0°~ 90°, Auto Flip 180°to Continue Monitor
Tilt speed	0.1~ 180°/s
Precision	±0.10°
Others	
Housing	Aluminum Alloy, Vandal Proof Housing Wall Mount
Lighting proof	6000V
Ingress protection	IP66
Work temp	-0°~+50°
Work humidity	0%~90%
Power	AC24V/2A
Weight	2.4KG
Zoom Lens Option	
SM-SDC611-QS12X	12X Samsung SCM-2121

SM-CM200

Ceiling Mount Bracket



SM-KB158

RS485 Surveillance Keyboard, Support PELCO matrix, Built-in multi-protocol



© 2010 SOMAX All rights reserved.

All rights of this object belong to SOMAX Reproduced or transmitted in any form, or by any means without the prior written permission of SOMAX is prohibited. SOMAX reserves the rights to modify its products, including their specifications and any other information stated herein without notice. The official printout of any information shall prevail should there be any discrepancy between the information contained herein and the information contained in that printout. "SOMAX" is a trademark owned by SOMAX Integrated Other trademarks used herein for description purpose only belong to each of their companies.

SOMAX
TECHNOLOGY OF SECURITY

SM-SDC611-Q27X

6-inch PTZ Dome, 32-bit ARM, IP67-rated, working temperature with -40°C~+60°C & 6000V Lightning proof

27X Optical Zoom



Key Features

- ✓ Support 256 presets, 32-bit software address.
- ✓ 32-bit ARM processor CPU, User management protection.
- ✓ 8 mission planning and 8 Editable vector path.
- ✓ 6 pattern (horizontal/vertical/zoom, and each can record up to 120 seconds).
- ✓ Compatibility with all Protocol: PELCO-D, PELCO-P, ULTRACK, VICON, SYNACOLOR.
- ✓ Compatible with Sony, Hitachi, CNB, Sanyo, Yoko, LG and Samsung.
- ✓ Optional multi-language for OSD operation menu.
- ✓ Working temperature with -40°C~+60°C
- ✓ IP67-Rated waterproof and 6000V Lightning proof.

Dimensions Unit: mm

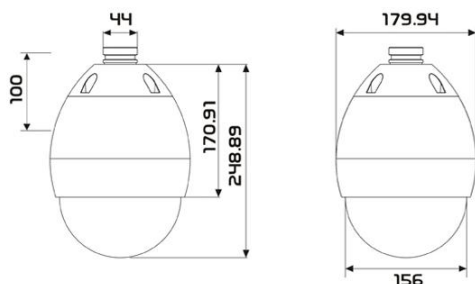

Technical Specification

Model NO.	SM-SDC611-Q27X
Zoom Module	
TV System	PAL/NTSC
CCD Sensor	1/3"SONY CCD
Effective Pixel	597(H)×537(V)
Lens	F=3.9~105.3mm
Zoom	27X Optical Zoom
Mini. Illumination	Color: 0.01LUX B/W:0.001LUX/0LUX
Horizontal Resolution	480TVL
S/N Ratio	>60dB
Electronic Shutter	PAL:1/50~1/10000sec. NTSC : 1/60~1/12000sec.
Video Output	1.0Vp-p 75Ω
Gamma	0.45
Scanning System	Internal Lens
Focus	Manual/Auto
Iris	Manual/Auto
White Balance	Auto
AGC	Manual/Auto
HLC	ON/OFF
Operation	
OSD menu	English, German, Russian, Italian and Spanish
Preset position	128 or 256 Preset Positions Optional
Scan	Auto scan and left-right limited scan, speed adjustable
Patrol	8 tracks, preset, speed and dwell time changeable
Pattern	6 Lines(Pan/Tilt/Zoom, every line can record up to 120 seconds)
Alarm	8 alarm inputs, 2 alarm outputs (optional)
Password protection	YES
Temperature display and Settings	YES(Temperature alarm set, Temperature Display)
Authority Management	YES
Private masking	Samsung : 8(Linked Private masking)
Address range	0~255 (Setup by dip switcher, firmware)
Communication	RS485 (+/-)
Baud rate	2400/4800/9600/19200
Protocol	PELCO-D,PELCO-P, ULTRACK, VICON, DYNACOLOR
Device title	Display on/off
Zoom times	Display on/off
Firmware Update interface	RS485 (+/-)
Mechanical	
Pan range	0°~ 360° continuously
Pan speed	0.1~ 360°/s
Tilt range	0°~ 90°, Auto Flip 180°to Continue Monitor
Tilt speed	0.1~ 180°/s
Precision	±0.10°
Others	
Housing	Aluminum Alloy, Vandal Proof Housing Wall Mount
Lighting proof	6000V
Ingress protection	IP67
Work temp	-40°~+60°
Work humidity	0%~90%
Power	AC24V/2.5A
Weight	4.2KG
Zoom Lens Option	
SM-SDC611-QS27X	27X Samsung SCM-2271

SM-CM300

Ceiling Mount Bracket



SM-KB158

RS485 Surveillance Keyboard, Support PELCO matrix, Built-in multi-protocol



© 2010 SOMAX All rights reserved.

All rights of this object belong to SOMAX Reproduced or transmitted in any form, or by any means without the prior written permission of SOMAX is prohibited. SOMAX reserves the rights to modify its products, including their specifications and any other information stated herein without notice. The official printout of any information shall prevail should there be any discrepancy between the information contained herein and the information contained in that printout. "SOMAX" is a trademark owned by SOMAX Integrated Other trademarks used herein for description purpose only belong to each of their companies.

SOMAX
TECHNOLOGY OF SECURITY

SM-SDC611-Q10X5

50Meters IR PTZ Dome with IP66 & 6000V Lightning proof
working temperature with -40°C~+60°C

50Meter IR 10X Optical Zoom



Key Features

- ✓ Support 256 presets, 32-bit software address.
- ✓ 32-bit ARM processor CPU, User management protection.
- ✓ 8 mission planning and 8 Editable vector path.
- ✓ 6 pattern (horizontal/vertical/zoom, and each can record up to 120 seconds).
- ✓ Compatibility with all Protocol: PELCO-D, PELCO-P, ULTRACK, VICON, SYNACOLOR.
- ✓ Compatible with Sony, Hitachi, CNB, Sanyo, Yoko, LG and Samsung.
- ✓ Optional multi-language for OSD operation menu.
- ✓ Working temperature with -40°C~+60°C
- ✓ IP67-Rated waterproof and 6000V Lightning proof.

Dimensions Unit: mm

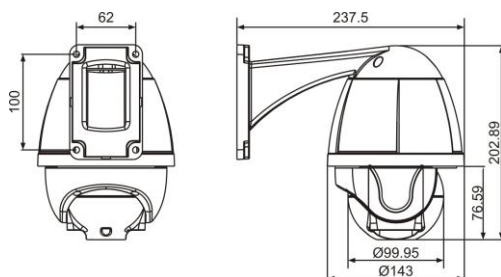

SM-KB158

RS485 Surveillance Keyboard,
Support PELCO matrix, Built-in multi-protocol

SM-CM400

Ceiling Mount Bracket

Technical Specification

Model NO.	SM-SDC611-Q10X5
Zoom Module	
TV System	PAL/NTSC
CCD Sensor	1/3"SONY CCD
Effective Pixel	PAL: 976(H)×582(V) NTSC:976(H) ×494(V)
Lens	F=5.5mm~55mm
Zoom	10X Optical Zoom
Mini. Illumination	Color: 0.01Lux/F1.2 B/W: 0.001Lux/F1.2
Horizontal Resolution	650TVL
S/N Ratio	>60dB
Electronic Shutter	PAL:1/50~1/10000sec. NTSC : 1/60~1/12000sec.
Video Output	1.0Vp-p 75Ω
Gamma	0.45
Scanning System	Internal Lens
Focus	Manual/Auto
Iris	Auto
White Balance	Auto/Manual
HLC	ON/OFF
Operation	
OSD menu	English, German, Russian, Italian and Spanish
Preset position	128 or 256 Preset Positions Optional
Scan	Auto scan and left-right limited scan, speed adjustable
Patrol	8 tracks, preset, speed and dwell time changeable
Pattern	6 Lines(Pan/Tilt/Zoom, every line can record up to 120 seconds)
Alarm	8 alarm inputs, 2 alarm outputs (optional)
Password protection	YES
Temperature display and Settings	YES(Temperature alarm set, Temperature Display)
Authority Management	YES
Private masking	Samsung : 8(Linked Private masking)
Address range	0~255 (Setup by dip switcher, firmware)
Communication	RS485 (+/-)
Baud rate	2400/4800/9600/19200
Protocol	PELCO-D,PELCO-P, ULTRACK, VICON, DYNACOLOR
Device title	Display on/off
Zoom times	Display on/off
Firmware Update interface	RS485 (+/-)
Mechanical	
Pan range	0°~ 360° continuously
Pan speed	0.1~ 360°/s
Tilt range	0°~ 90°, Auto Flip 180°to Continue Monitor
Tilt speed	0.1~ 180°/s
Precision	±0.10°
Infrared	
IR Distance	50 Meters
IR Control	Auto/Manual
IR Driver	PWM
IR Detect Time	2~15s, Sync with the Camera
IR Light Level	0~30 Adjustable
IR Sensitivity	0~30 Adjustable
Standby Level	OFF/1~30 Adjustable
IR Mode	Auto/Far/Near/Far Near/Close
Others	
Housing	Aluminum Alloy, Vandal Proof Housing Wall Mount
Lighting proof	6000V
Ingress protection	IP66
Work temp	-40°~+60°
Work humidity	0%~90%
Power	AC24V/3A
Weight	4.2KG
Zoom Lens Option	
SM-SDC611-QS10X5	27X Samsung SCM-2271



© 2010 SOMAX All rights reserved.

All rights of this object belong to SOMAX Reproduced or transmitted in any form, or by any means without the prior written permission of SOMAX is prohibited. SOMAX reserves the rights to modify its products, including their specifications and any other information stated herein without notice. The official printout of any information shall prevail should there be any discrepancy between the information contained herein and the information contained in that printout. "SOMAX" is a trademark owned by SOMAX Integrated Other trademarks used herein for description purpose only belong to each of their companies.

SOMAX
TECHNOLOGY OF SECURITY

SM-SDC611-Q27X15

7-inch 150Meters IR PTZ Dome with 32-bit ARM and working temperature -40°C~+60°C with IP66 & 6000V Lightning proof

150Meter IR 27X Optical Zoom



Key Features

- ✓ Support 256 presets, 32-bit software address.
- ✓ 32-bit ARM processor CPU, User management protection.
- ✓ 8 mission planning and 8 Editable vector path.
- ✓ 6 pattern (horizontal/vertical/zoom, and each can record up to 120 seconds).
- ✓ Compatibility with all Protocol: PELCO-D, PELCO-P, ULTRACK, VICON, SYNACOLOR.
- ✓ Compatible with Sony, Hitachi, CNB, Sanyo, Yoko, LG and Samsung.
- ✓ Optional multi-language for OSD operation menu.
- ✓ Working temperature with -40°C~+60°C
- ✓ IP67-Rated waterproof and 6000V Lightning proof.

Dimensions ----- Unit: mm

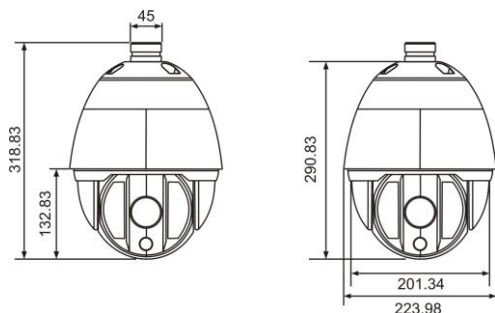

SM-KB158

RS485 Surveillance Keyboard,
Support PELCO matrix, Built-in multi-protocol

SM-CM500

Ceiling Mount Bracket

Technical Specification

Model NO.	SM-SDC611-Q27X15
Zoom Module	
TV System	PAL/NTSC
CCD Sensor	1/3" Sony ExView HAD
Effective Pixel	PAL: 976(H) × 582(V) NTSC: 976(H) × 494(V)
Lens	F=3.9~105.3mm
Zoom	27X Optical Zoom
Mini. Illumination	Color: 0.01Lux/F1.2 B/W: 0.001Lux/F1.2
Horizontal Resolution	650TVL
S/N Ratio	>60dB
Electronic Shutter	PAL: 1/50~1/10000sec. NTSC : 1/60~1/12000sec.
Video Output	1.0Vp-p 75Ω
Gamma	0.45
Scanning System	Internal Lens
Focus	Manual/Auto
Iris	Manual/Auto
White Balance	Auto
Support	Day/Night, Black to Color, IR-CUT, AGC
Operation	
OSD menu	English, German, Russian, Italian and Spanish
Preset position	128 or 256 Preset Positions Optional
Scan	Auto scan and left-right limited scan, speed adjustable
Patrol	8 tracks, preset, speed and dwell time changeable
Pattern	6 Lines(Pan/Tilt/Zoom, every line can record up to 120 seconds)
Alarm	8 alarm inputs, 2 alarm outputs (optional)
Password protection	YES
Temperature display and Settings	YES(Temperature alarm set, Temperature Display)
Authority Management	YES
Private masking	Samsung : 8(Linked Private masking)
Address range	0~255 (Setup by dip switcher, firmware)
Communication	RS485 (+/-)
Baud rate	2400/4800/9600/19200
Protocol	PELCO-D, PELCO-P, ULTRACK, VICON, DYNACOLOR
Device title	Display on/off
Zoom times	Display on/off
Firmware Update interface	RS485 (+/-)
Mechanical	
Pan range	0°~ 360° continuously
Pan speed	0.1~ 360°/s
Tilt range	0°~ 90°, Auto Flip 180°to Continue Monitor
Tilt speed	0.1~ 180°/s
Precision	±0.10°
Infrared	
IR Distance	150 Meters
IR Control	Auto/Manual
IR Driver	PWM
IR Detect Time	2~15s, Sync with the Camera
IR Light Level	0~30 Adjustable
IR Sensitivity	0~30 Adjustable
Standby Level	OFF/1~30 Adjustable
IR Mode	Auto/Far/Near/Far Near/Close
Others	
Housing	Aluminum Alloy, Vandal Proof Housing Wall Mount
Lighting proof	6000V
Ingress protection	IP66
Work temp	-40°~+60°
Work humidity	0%~90%
Power	AC24V/4A
Weight	4.8KG
Zoom Lens Option	
SM-SDC611-QS27X15	27X Samsung SCM-2271



© 2010 SOMAX All rights reserved.

All rights of this object belong to SOMAX Reproduced or transmitted in any form, or by any means without the prior written permission of SOMAX is prohibited. SOMAX reserves the rights to modify its products, including their specifications and any other information stated herein without notice. The official printout of any information shall prevail should there be any discrepancy between the information contained herein and the information contained in that printout. "SOMAX" is a trademark owned by SOMAX Integrated Other trademarks used herein for description purpose only belong to each of their companies.

SOMAX
TECHNOLOGY OF SECURITY

SM-SDC611-Q27XAT

Outdoor, 32bit ARM, IP66-rated, Auto Tracking PTZ temperature with -40°C~+60°C & 6000V Lightning proof

Auto Tracking 27X Optical Zoom



Features

- ✓ Target Tracking: Size is programmable
- ✓ Tracking sensitivity: Programmable
- ✓ Tracking Function: On/Off
- ✓ Tracking Auto Zoom: On/Off
- ✓ Target give up time: Programmable
- ✓ Support 256 presets, 32-bit software address.
- ✓ 32-bit ARM processor CPU, User management protection.
- ✓ 8 mission planning and 8 Editable vector path.
- ✓ Compatibility with all Protocol: PELCO-D, PELCO-P, ULTRACK, VICON, SYNACOLOR.
- ✓ Compatible with Sony, Hitachi, CNB, Sanyo, Yoko, LG and Samsung.
- ✓ IP66-Rated waterproof and 6000V Lightning proof.

Dimensions Unit: mm

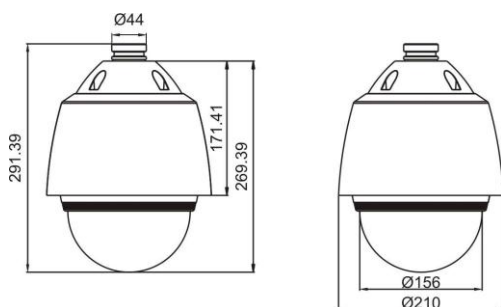

Technical Specification

Model NO.	SM-SDC611-Q27XAT
Zoom Module	
TV System	PAL/NTSC
CCD Sensor	1/3"SONY CCD
Effective Pixel	597(H)×537(V)
Lens	F=3.9~105.3mm
Zoom	27X Optical Zoom
Mini. Illumination	Color: 0.01LUX B/W:0.001LUX/0LUX
Horizontal Resolution	650TVL
S/N Ratio	>60dB
Electronic Shutter	PAL:1/50~1/10000sec. NTSC : 1/60~1/12000sec.
Video Output	1.0Vp-p 75Ω
Gamma	0.45
Scanning System	Internal Lens
Focus	Manual/Auto
Iris	Manual/Auto
White Balance	Auto
AGC	Manual/Auto
HLC	ON/OFF
Operation	
OSD menu	English, German, Russian, Italian and Spanish
Preset position	128 or 256 Preset Positions Optional
Scan	Auto scan and left-right limited scan, speed adjustable
Patrol	8 tracks, preset, speed and dwell time changeable
Pattern	6 Lines(Pan/Tilt/Zoom, every line can record up to 120 seconds)
Alarm	8 alarm inputs, 2 alarm outputs (optional)
Password protection	YES
Temperature display and Settings	YES(Temperature alarm set, Temperature Display)
Authority Management	YES
Private masking	Samsung : 8(Linked Private masking)
Address range	0~255 (Setup by dip switcher, firmware)
Communication	RS485 (+/-)
Baud rate	2400/4800/9600/19200
Protocol	PELCO-D,PELCO-P, ULTRACK, VICON, DYNACOLOR
Device title	Display on/off
Zoom times	Display on/off
Firmware Update interface	RS485 (+/-)
Mechanical	
Pan range	0°~ 360° continuously
Pan speed	0.1~ 360°/s
Tilt range	0°~ 90°, Auto Flip 180°to Continue Monitor
Tilt speed	0.1~ 180°/s
Precision	±0.10°
Others	
Housing	Aluminum Alloy, Vandal Proof Housing Wall Mount
Lighting proof	6000V
Ingress protection	IP66
Work temp	-40°~+60°
Work humidity	0%~90%
Power	AC24V/2.5A
Weight	4.2KG
Zoom Lens Option	
SM-SDC611-QS27XAT	27X Samsung SCM-2271

SM-CM300

Ceiling Mount Bracket



SM-KB158

RS485 Surveillance Keyboard, Support PELCO matrix, Built-in multi-protocol



© 2010 SOMAX All rights reserved.

All rights of this object belong to SOMAX Reproduced or transmitted in any form, or by any means without the prior written permission of SOMAX is prohibited. SOMAX reserves the rights to modify its products, including their specifications and any other information stated herein without notice. The official printout of any information shall prevail should there be any discrepancy between the information contained herein and the information contained in that printout. "SOMAX" is a trademark owned by SOMAX Integrated Other trademarks used herein for description purpose only belong to each of their companies.

SOMAX
TECHNOLOGY OF SECURITY

SM-KB158

RS485 Surveillance Keyboard, Support PELCO matrix, Built-in multi-protocol

3-Axis Keyboard



Key Features

- ✓ Support PELCO matrix
- ✓ Support 4 keyboards linkage, each keyboard can support 32 domes at most
- ✓ According to ergonomics design, it is used expediently and comfortably
- ✓ LED with back-light, a display command menu, protocol, current camera ID, output display ID and joystick status
- ✓ Three axis joystick can control the speed of pan/tilt and lens magnification
- ✓ Built-in multi-protocol, Baud rate can be selectable
- ✓ Support all the shortcut key of the dome to handle

Technical Specification

Model NO.	SM-KB158
Operation	
On Screen Display	English
LCD	Display command menu, protocol, current camera ID, output display ID and joystick status
Max Dome Connection	Available to connect with 32pcs High Speed Dome
Protocol	Built-in multi-protocol such as Pelco_P, Pelco_D, VIDO_B02, Pelco matrix and so on; Baud rate can be selected
Electrify	Auto-test the baud rate, protocol and object dome and object monitor
Dome lens control	Zoom, Focus and Iris Control
Dome function operation	Preset/Scan/Pattern/Tour Setup
Communication interface	RS485, RS422, RJ45
RS485/RS422	DVR, PTZ Dome
Rj45	Matrix Connection
Matrix	Support PELCO Matrix
Keyboards linkage	Max 4Pcs SM-KB158
Communication frequency	2400, 4800, 9600, 19200Bps
Communication distance	1.2km (RS485 and RS422 can achieve it)
Baud Rate	2400Rate
Environmental	
Operation Temperature	-0°C ~ 50°C
Storage Temperature	-20°C ~ 50°C
Electrical	
Input Voltage/Current	9V-12VAC/DC
Adapter Requirement	DC12V1.5A
Mechanical	
Joystick	Three Axis
Joystick Operation	control speed of pan/ tilt and zoom in/out; Two axis joystick can control speed of pan/ tilt
Color	Black
Material	Plastic
Dimensions	218*180*55mm
Net Weight	0.32Kg

Dimensions ----- Unit: mm

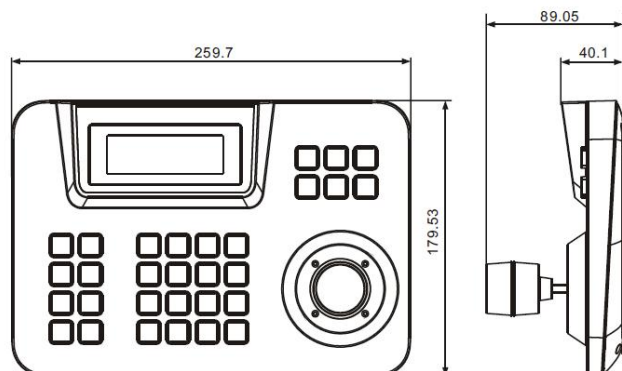

© 2010 SOMAX All rights reserved.

All rights of this object belong to SOMAX. Reproduced or transmitted in any form, or by any means without the prior written permission of SOMAX is prohibited. SOMAX reserves the rights to modify its products, including their specifications and any other information stated herein without notice. The official printout of any information shall prevail should there be any discrepancy between the information contained herein and the information contained in that printout. "SOMAX" is a trademark owned by SOMAX. Integrated Other trademarks used herein for description purpose only belong to each of their companies.

SOMAX
TECHNOLOGY OF SECURITY